



# SSR-L16

Brightness Sensor

Specification V1.2

## Overview

- Monitor environmental brightness, and auto adjust the brightness of LED display according to environmental brightness value and brightness adjustment strategy set up before, to achieve the aim of environmental protection and ensuring best viewing effect;
- Connect with iM9 multifunction card with 4 optional extended interfaces;
- Standard wire length: 5 meters, can be lengthened;
- For outdoor use, three proofing properties included;
- Do not require an external power supply;
- Appearance size:  $\varnothing 32 \times 41$ .

## Specification

Rated voltage	5V
Working temperature	-20°C—75°C
Working humidity	0—99%
Brightness range	0—65535 lux

## Hardware Connection

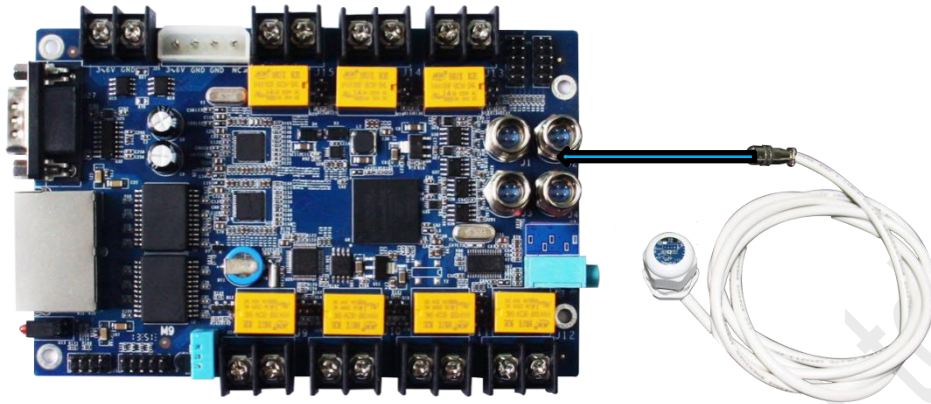

## Dimensions

Unit: mm

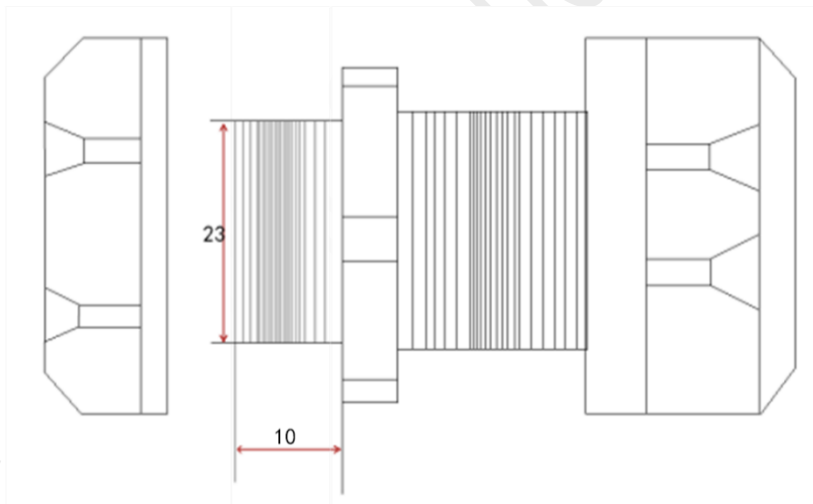

## Statement

Thank you for purchasing the product of Colorlight Cloud Tech Ltd. If you encounter any problems during use or have any suggestions, please contact us through official channels. We will do our best to provide support and listen to your valuable suggestions. We will constantly make improvements on technical specifications but without notice. You can visit [www.colorlightinside.com](http://www.colorlightinside.com) to get more updated information.



Colorlight Cloud Tech Ltd